



# 4.63G EVO

WHEEL LOADER  
"Z" LINKAGE



## DIESEL ENGINE

4-cylinder in-line engine, direct injection with mechanical control, water-cooled, dry filtration, particulate filter.

Type	Yanmar 4TNV98	Yanmar 4TNV98T
Max. power	54kW - 73HP	66 kW - 90 HP
Rated rpm	2.500	2.500
Power ISO/TR 14396	52 kW - 71 HP	62,5 kW - 85 HP
Power EEC 80/1269	52 kW - 71 HP	62,5 kW - 85 HP
Max. torque	Nm 234	Nm 317
Bore	mm 98	mm 98
Stroke	mm 110	mm 110
Displacement	cm <sup>3</sup> 3.319	cm <sup>3</sup> 3.319
Aspiration	Natural	Turbocharged
Emission standard	Tier IIIA	Tier II



## ELECTRIC SYSTEM

Battery	12 Volt
Capacity EN 60095-1	100 Ah - 850 A
Alternator rating	40 A
Reverse warning	Standard
Wiring according to	IP 67 - DIN 40050



## TRANSMISSION

Hydrostatic transmission with automatic power regulation and closed circuit with pumps and variable displacement engine. Two speed fwd/rev, with single-lever electronic control.

Work speed	Forward	Reverse
1 <sup>st</sup> gear km/h	0÷7	0÷7
2 <sup>nd</sup> gear km/h	0÷30	0÷30

\* 2<sup>nd</sup> gear automatic selection available as optional



## AXLES

Two heavy duty equal size axles with planetary final drives in each wheel. Fixed rigid drive axle. Oscillation rear axle on rear chassis section up to a total angle of 25°. Transfer gearbox transferring movement directly to the rear and to the front axle via transmission shaft. Self locking limited slip differential on front axle. Self locking limited slip differential on rear axle (optional).



## BRAKES

Service: hydraulic multi-disc oil brake on front axle working on all the wheels.

Parking brake: mechanical operating on service brake.



## TYRES

Standard	16/70 x 20
Optional	400/70 R20 • 405/70 R20 • 14.5 x 20



## STEERING

Servo-assisted steering LOAD SENSING system.

Total steering angle	80°
Inner tyres turning radius	mm 2.585
External turning radius	mm 4.515
External bucket turning radius*	mm 4.980

\* Bucket on traveling condition



## HYDRAULIC SYSTEM

Two gear pump, the first for loader and steering circuit with LOAD SENSING valve, the second for the fan circuit with two rotating speed. Modular two-element control valve with main relief valve. Double acting hydraulic cylinders. Hydraulic oil cooling radiator. Full flow oil filter on the return line. Single lever arm to control 4 position lifting system and 3 position bucket system.

Max flow	lt/1'	70
Max flow with kit high flow (optional).	lt/1'	100
Loader relief valve pressure	bar	240
Steering relief valve pressure	bar	190
Lift cylinder	mm	85x580
Bucket cylinder	mm	90x402
Lifting time (full)	sec.	5.37
Lowering Time (empty)	sec.	4.36
Unloading Time	sec.	2.32
Total cycle time	sec.	12.05



## SERVICE CAPACITIES

Engine	lt	11
Front axle	lt	5,6
Rear axle	lt	5,8
Gearbox	lt	3,8
Hydraulic circuit	lt	70
Brake circuit	lt	1,1
Fuel	lt	75
Water cooling	lt	15



## TECHNICAL FEATURES

Standard bucket capacity [*]	m <sup>3</sup>	1,1
Bucket width	mm	2.000
Straight static tipping load	kg	4.600
Full turned tipping load 40°	kg	4.200
Lifting capacity at max. height	kg	4.150
Hinge pin height	mm	3.360
Dump height at 40°	mm	2.685
Reach at 40°	mm	660
Breakout force	kg	6.400

\* fill factor 110%



## DIMENSIONS AND WEIGHT

Max length in transfer position	mm	5.295
Max width in transfer position	mm	2.000
Max external width	mm	1.873
Track width	mm	1.530
Wheel base	mm	2.275
Ground clearance	mm	330
Max height	mm	2.760
Standard operating weight	kg	6.010
Max permissible weight	kg	6.200



# 4.63G EVO

WHEEL LOADER  
"Z" LINKAGE

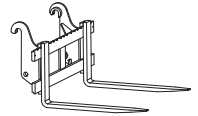
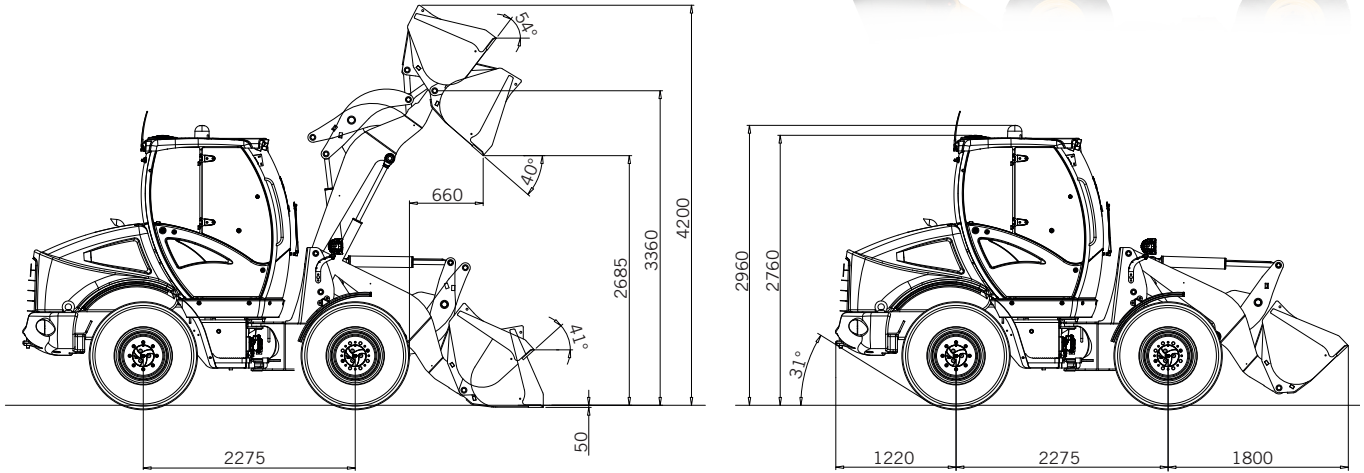

## PERFORMANCE DATA

		UNIVERSAL BUCKET	MULTI PUPOSE BUCKET	OVERSIZE	FORKS
Full load bucket capacity (SAE)	m <sup>3</sup>	1,1	0,8	1,7	/
Material density	ton/m <sup>3</sup>	1,8	1,8	1,2	/
Bucket width	mm	2.000	2.100	2.250	/
Bucket weight	kg	350	450	450	/
Overall operating height, fully raised	mm	4.200	4.050	4.150	/
Forks lengthh (Standard)	mm				1.000
Forks lengthh (Optional)	mm				1.200
Hinge pin height	mm	3.360	3.360	3.360	/
Dump clearance	°	40°	40°	40°	/
Dump height	mm	2.685	2.660	2.635	/
Dump distance	mm	660	635	710	/
Bucket static tipping load, straight	kg	4.600	4.850	4.400	/
Bucket static tipping load, full turn	kg	4.200	4.450	4.000	/
Forks static tipping load, full turn	kg				3.200
Payload EN 474-3 (80%) [•]	kg				2.560
Payload EN 474-3 (60%) [•]	kg				1.920
Breakout force	kg	6.400	6.900	6.000	/
Total length	mm	5.295	5.425	5.525	/
External bucket turning radius	mm	4.980	4.940	5.090	/
Standard operating weight	kg	6.010	6.110	6.110	/

[•] Loading center 500 mm



**VENIERI**

Via Piratello, 106 - 48022 Lugo (RA) ITALY  
Tel. +39 0545 904411 Fax +39 0545 30389  
e-mail: info@vf-venieri.com [www.vf-venieri.com](http://www.vf-venieri.com)  
**Spare parts**  
Tel. +39 0545 904429 Fax +39 0545 24555